

NOTE: NBTGS & NCTGS EJECTORS HAVE THE SAME OPERATING CHARACTERISTICS

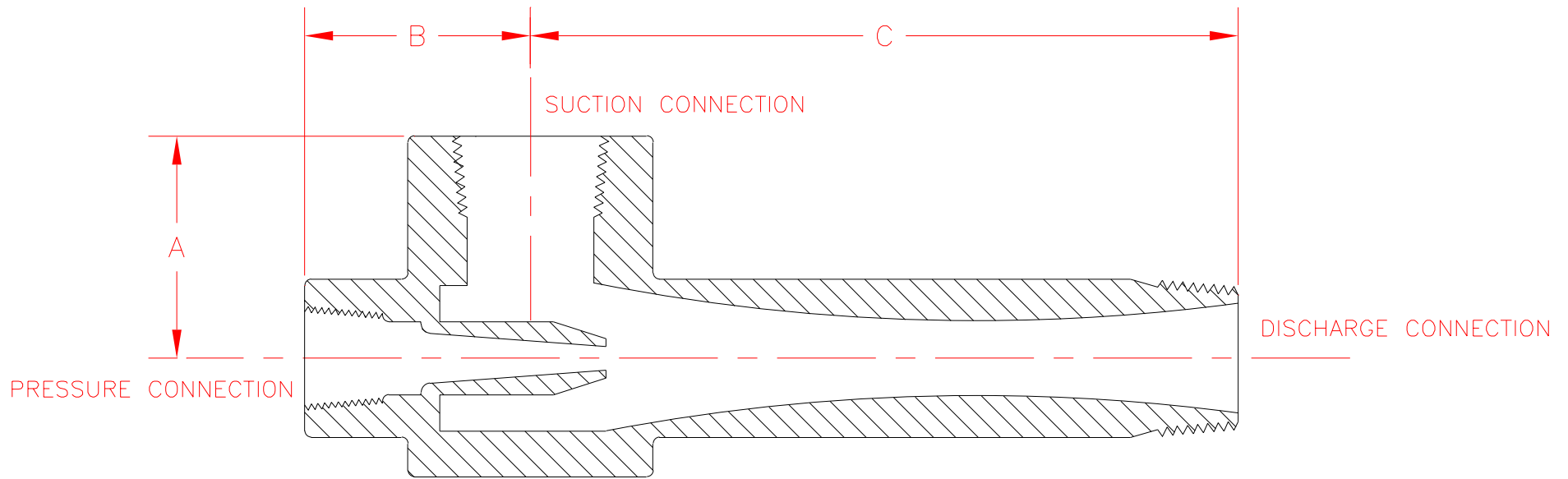

CAPACITY FACTOR	MODEL	DIM. A	DIM. B	DIM. C	PRESSURE CONNECTION	SUCTION & DISCHARGE CONNECTION
0.027	NBTGS00	15/16"	2"	2-3/8"	3/8" NPT	3/8" NPT
0.050	NBTGS0	15/16"	2-13/16"	2-5/8"	3/8" NPT	3/8" NPT
0.091	NBTGS1	1-1/4"	1-1/2"	3"	3/8" NPT	1/2" NPT
0.165	NBTGS2	1-3/8"	1-7/16"	3-7/16"	1/2" NPT	3/4" NPT
0.30	NBTGS3	1-3/4"	1-7/8"	4-1/2"	3/4" NPT	1" NPT
0.55	NBTGS4	2"	1-15/16"	6-1/4"	1" NPT	1-1/2" NPT
1.00	NBTGS5	2"	2"	8"	1" NPT	1-1/2" NPT
1.80	NBTGS6	3"	3-1/4"	10-7/8"	1-1/2" NPT	2" NPT
3.24	NBTGS7	3-1/2"	4-3/4"	14-1/2"	2" NPT	2-1/2" NPT
4.30	NBTGS8	4"	5"	16"	2" NPT	3" NPT
5.71	NBTGS9	4"	5"	19-1/8"	2" NPT	3" NPT
7.57	NBTGS10	5-1/4"	10-1/2"	22"	3" NPT	4" NPT
10.1	NBTGS11	5-1/4"	10-1/2"	25-3/8"	3" NPT	4" NPT

PRELIMINARY

DO NOT SCALE

NO.	DATE	REVISION	BY
<b>ELMRIDGE</b> TORONTO, ONTARIO CANADA LIVONIA, MICHIGAN USA			
PROJECT : Gas-Jet Solids Ejectors			
PART : NBTGS Dimensions - Welded Style			
MATERIAL :			QTY.:
UNLESS OTHERWISE SPECIFIED, GENERAL TOLERANCES: X/X = ± 1/32" XX = ± .010 XXX = ± .002 DEG. = ± 1/2°		SCALE : None	RELEASE DATE :
		DRAWN BY : B.W.	DATE : 8/14/95
		APPROVED BY :	DATE :
NOTE :		DRAWING NUMBER	REV.NO.
		NBTGS-D	1051 - A 1.1

DIMENSIONS AND SPECIFICATIONS ARE SUBJECT TO CHANGE WITHOUT NOTICE