

NOTE: NBTLS & NCTLS EDUCTORS HAVE THE SAME OPERATING CHARACTERISTICS

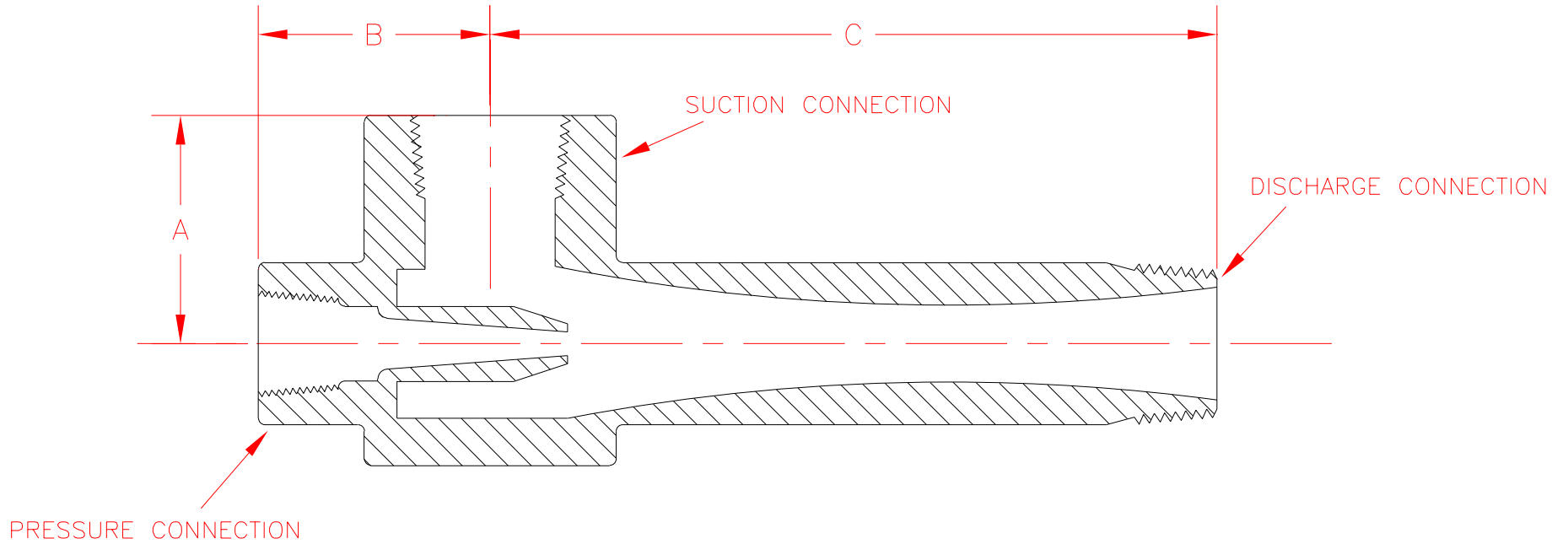

CAPACITY FACTOR	MODEL	DIM. A	DIM. B	DIM. C	PRESSURE CONNECTION	SUCTION & DISCHARGE CONNECTION
0.091	NBTLS1	1-1/4"	1-1/2"	3"	3/8" NPT	1/2" NPT
0.165	NBTLS2	1-3/8"	1-7/16"	3-7/16"	1/2" NPT	3/4" NPT
0.30	NBTLS3	1-3/4"	1-7/8"	4-1/2"	3/4" NPT	1" NPT
0.55	NBTLS4	2"	1-15/16"	6-1/4"	1" NPT	1-1/2" NPT
1.00	NBTLS5	2"	2"	8"	1" NPT	1-1/2" NPT
1.80	NBTLS6	3"	3-1/4"	10-7/8"	1-1/2" NPT	2" NPT
3.24	NBTLS7	3-1/2"	4-3/4"	14-1/2"	2" NPT	2-1/2" NPT
4.30	NBTLS8	4"	5"	16"	2" NPT	3" NPT
5.71	NBTLS9	4"	5"	19-1/8"	2" NPT	3" NPT
7.57	NBTLS10	5-1/4"	10-1/2"	22"	3" NPT	4" NPT
10.1	NBTLS11	5-1/4"	10-1/2"	25-3/8"	3" NPT	4" NPT

PRELIMINARY

DO NOT SCALE

NO.	DATE	REVISION	BY
ELMRIDGE TORONTO, ONTARIO CANADA LIVONIA, MICHIGAN USA			
PROJECT: Liqui-Jet Solids Eductors			
PART: NBTLS Dimensions - Welded Style			
MATERIAL:			QTY.:
UNLESS OTHERWISE SPECIFIED, GENERAL TOLERANCES: X/XX = ± 1/32" .XX = ± .010 .XXX = ± .001 DEG. = ± 1/2°		SCALE: None	RELEASE DATE:
		DRAWN BY: S.D.B.	DATE: 10/95
		APPROVED BY:	DATE:
NOTE: NBTLS-D		DRAWING NUMBER 1260	REV.NO. 1.3

DIMENSIONS AND SPECIFICATIONS ARE SUBJECT TO CHANGE WITHOUT NOTICE