

NOTE: NBLST & NCTLST EDUCTORS HAVE THE SAME OPERATING CHARACTERISTICS

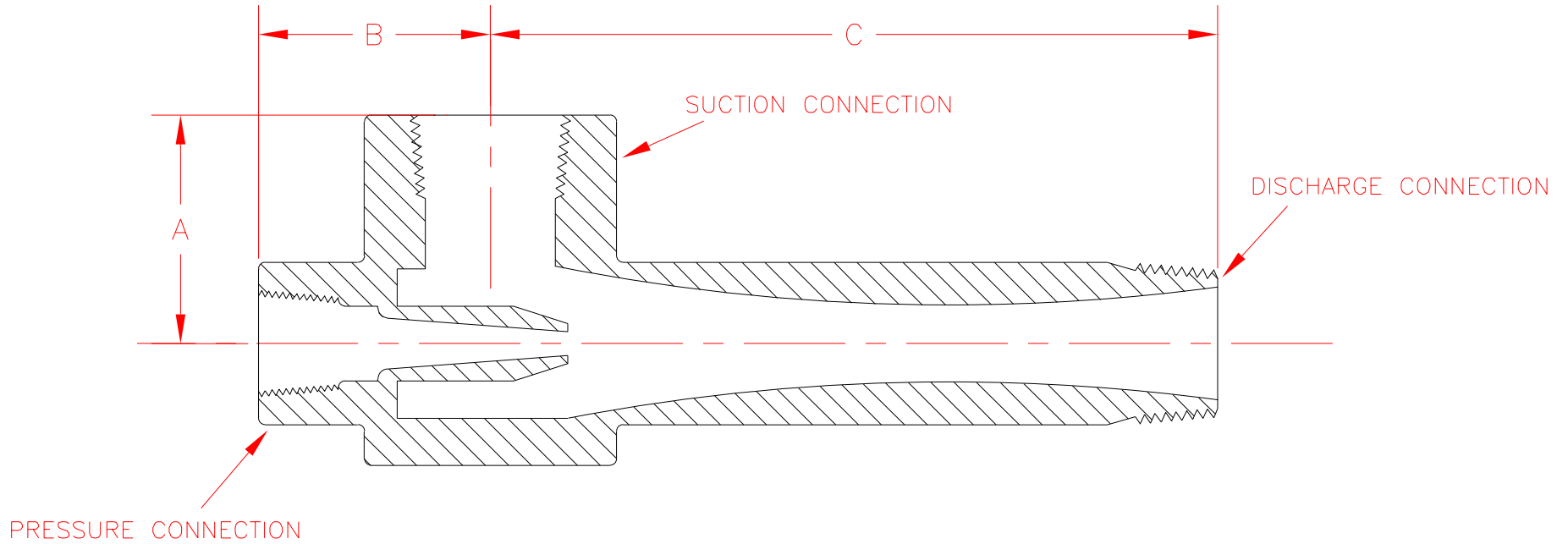

| CAPACITY FACTOR | MODEL | DIM. A | DIM. B | DIM. C | PRESSURE CONNECTION | SUCTION & DISCHARGE CONNECTION |
|-----------------|---------|--------|----------|---------|---------------------|--------------------------------|
| 0.091 | NBLST1 | 1-1/4" | 1-1/2" | 3" | 3/8" NPT | 1/2" NPT |
| 0.165 | NBLST2 | 1-3/8" | 1-7/16" | 3-7/16" | 1/2" NPT | 3/4" NPT |
| 0.30 | NBLST3 | 1-3/4" | 1-7/8" | 4-1/2" | 3/4" NPT | 1" NPT |
| 0.55 | NBLST4 | 2" | 1-15/16" | 6-1/4" | 1" NPT | 1-1/2" NPT |
| 1.00 | NBLST5 | 2" | 2" | 8" | 1" NPT | 1-1/2" NPT |
| 1.80 | NBLST6 | 3" | 3-1/4" | 10-7/8" | 1-1/2" NPT | 2" NPT |
| 3.24 | NBLST7 | 3-1/2" | 4-3/4" | 14-1/2" | 2" NPT | 2-1/2" NPT |
| 4.30 | NBLST8 | 4" | 5" | 16" | 2" NPT | 3" NPT |
| 5.71 | NBLST9 | 4" | 5" | 19-1/8" | 2" NPT | 3" NPT |
| 7.57 | NBLST10 | 5-1/4" | 10-1/2" | 22" | 3" NPT | 4" NPT |
| 10.1 | NBLST11 | 5-1/4" | 10-1/2" | 25-3/8" | 3" NPT | 4" NPT |

PRELIMINARY

DO NOT SCALE

| NO. | DATE | REVISION | BY |
|--|------|------------------------|----------------|
| ELMRIDGE TORONTO, ONTARIO CANADA LIVONIA, MICHIGAN USA | | | |
| PROJECT : Liqui-Jet Solids Eductors | | | |
| PART : NBLST Dimensions - Welded Style | | | |
| MATERIAL : | | | QTY.: |
| UNLESS OTHERWISE SPECIFIED, GENERAL TOLERANCES: X/X = ± 1/32" .XX = ± .01" .XXX = ± .001" DEG. = ± 1/2° | | SCALE : None | RELEASE DATE : |
| | | DRAWN BY : B.W. | DATE : 10/95 |
| | | APPROVED BY : | DATE : |
| NOTE : | | DRAWING NUMBER 2065 | REV.NO. 1.0 |
| TLS-NBLST-6-D | | | |

DIMENSIONS AND SPECIFICATIONS ARE SUBJECT TO CHANGE WITHOUT NOTICE