

NOTE: NBTLLM & NCTLLM EDUCTORS HAVE THE SAME OPERATING CHARACTERISTICS

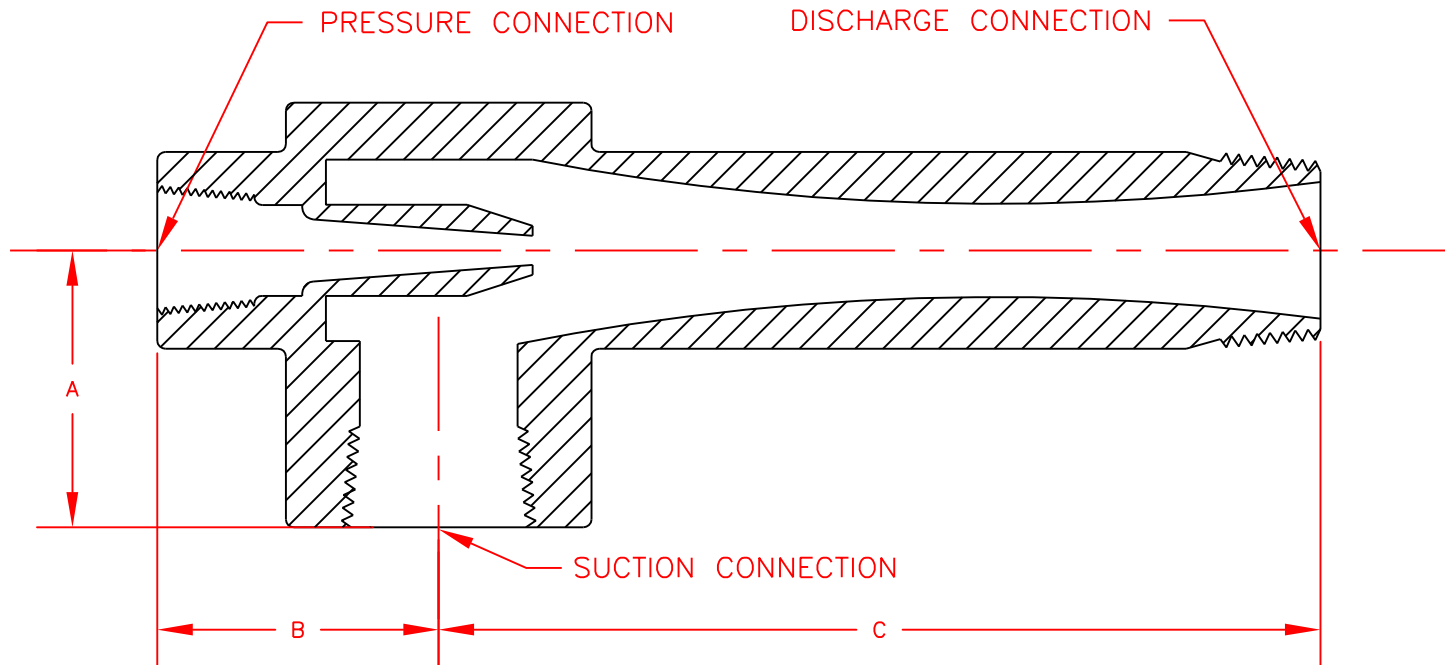

| CAPACITY FACTOR | MODEL    | DIM. A | DIM. B   | DIM. C  | PRESSURE CONNECTION | SUCTION & DISCHARGE CONNECTION |
|-----------------|----------|--------|----------|---------|---------------------|--------------------------------|
| 0.027           | NBTLLM00 | 15/16" | 2"       | 2-3/8"  | 3/8" NPT            | 3/8" NPT                       |
| 0.050           | NBTLLM0  | 15/16" | 2-13/16" | 2-5/8"  | 3/8" NPT            | 3/8" NPT                       |
| 0.091           | NBTLLM1  | 1-1/4" | 1-1/2"   | 3"      | 3/8" NPT            | 1/2" NPT                       |
| 0.165           | NBTLLM2  | 1-3/8" | 1-7/16"  | 3-7/16" | 1/2" NPT            | 3/4" NPT                       |
| 0.30            | NBTLLM3  | 1-3/4" | 1-7/8"   | 4-1/2"  | 3/4" NPT            | 1" NPT                         |
| 0.55            | NBTLLM4  | 2"     | 1-15/16" | 6-1/4"  | 1" NPT              | 1-1/2" NPT                     |
| 1.00            | NBTLLM5  | 2"     | 2"       | 8"      | 1" NPT              | 1-1/2" NPT                     |
| 1.80            | NBTLLM6  | 3"     | 3-1/4"   | 10-7/8" | 1-1/2" NPT          | 2" NPT                         |
| 3.24            | NBTLLM7  | 3-1/2" | 4-3/4"   | 14-1/2" | 2" NPT              | 2-1/2" NPT                     |
| 4.30            | NBTLLM8  | 4"     | 5"       | 16"     | 2" NPT              | 3" NPT                         |
| 5.71            | NBTLLM9  | 4"     | 5"       | 19-1/8" | 2" NPT              | 3" NPT                         |
| 7.57            | NBTLLM10 | 5-1/4" | 10-1/2"  | 22"     | 3" NPT              | 4" NPT                         |
| 10.1            | NBTLLM11 | 5-1/4" | 10-1/2"  | 25-3/8" | 3" NPT              | 4" NPT                         |

DIMENSIONS AND SPECIFICATIONS ARE SUBJECT TO CHANGE WITHOUT NOTICE

| NO.   | DATE | REVISION                         | BY             |
|---|------|----------------------------------|----------------|
|   |      |                                  |                |
| PROJECT :   |      | Liqui-Jet Eductors               |                |
| PART :  |      | NBTLLM Dimensions - Welded Style |                |
| MATERIAL :  |      |                                  | QTY.:          |
| <small>UNLESS OTHERWISE SPECIFIED, GENERAL TOLERANCES:</small><br><del>X/X = ± 1/32"</del><br><del>XX = ± .010</del><br><del>XXX = ± .002</del><br><del>DEG. = ± 1/2°</del> |      | SCALE : None                     | RELEASE DATE : |
|   |      | DRAWN BY : S.D.B.                | DATE : 3/21/99 |
|   |      | APPROVED BY :                    | DATE :         |
| NOTE :  |      | DRAWING NUMBER                   | REV.NO.        |
|   |      | NBTLLM-6-D                       | 1830 - A 1.1   |