

NOTE: NBTLLM & NCTLLM EDUCTORS HAVE THE SAME OPERATING CHARACTERISTICS

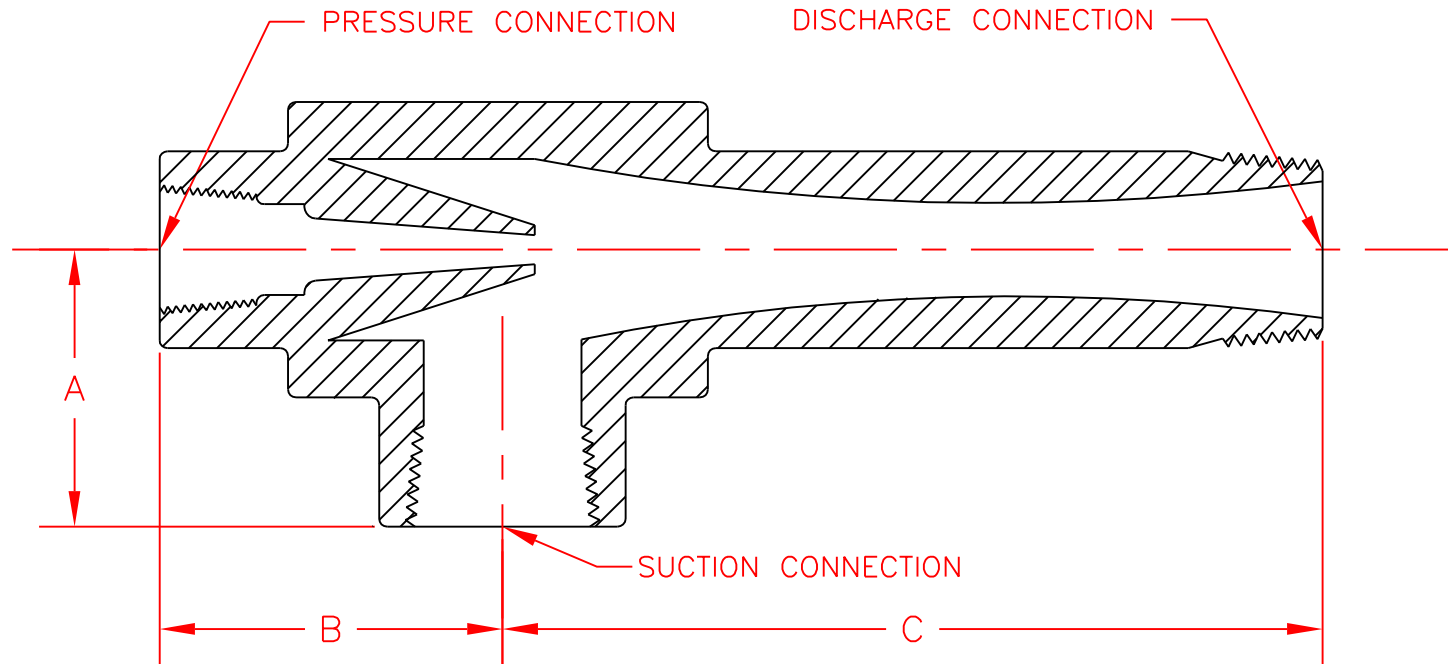

CAPACITY FACTOR	MODEL	DIM. A	DIM. B	DIM. C	PRESSURE CONNECTION	SUCTION & DISCHARGE CONNECTION
0.027	NBTLLM00	15/16"	2"	2-3/8"	3/8" NPT	3/8" NPT
0.050	NBTLLM0	15/16"	2-13/16"	2-5/8"	3/8" NPT	3/8" NPT
0.091	NBTLLM1	1-3/8"	2-15/16"	2-3/4"	3/8" NPT	1/2" NPT
0.165	NBTLLM2	1-3/4"	2-11/16"	3-3/8"	1/2" NPT	3/4" NPT
0.30	NBTLLM3	1-7/8"	2-7/8"	4-1/2"	3/4" NPT	1" NPT
0.55	NBTLLM4	2-7/16"	3-7/8"	6-3/16"	1" NPT	1-1/2" NPT
1.00	NBTLLM5	2-7/16"	3-13/16"	8"	1" NPT	1-1/2" NPT
1.80	NBTLLM6	2-3/4"	4-1/8"	10-3/4"	1-1/2" NPT	2" NPT
3.24	NBTLLM7	3-5/16"	4-11/16"	14-1/2"	2" NPT	2-1/2" NPT
4.30	NBTLLM8	3-3/4"	6"	16"	2" NPT	3" NPT
5.71	NBTLLM9	4-5/8"	6"	18-7/8"	3" NPT	4" NPT
7.57	NBTLLM10	4-5/8"	6"	21-5/8"	3" NPT	4" NPT

DIMENSIONS AND SPECIFICATIONS ARE SUBJECT TO CHANGE WITHOUT NOTICE

PRELIMINARY  
DO NOT SCALE

NO.	DATE	REVISION	BY
PROJECT :		Liqui-Jet Eductors	
PART :		NBTLLM Dimensions - Plastic	
MATERIAL :			QTY.:
<small>UNLESS OTHERWISE SPECIFIED, GENERAL TOLERANCES:</small> X/X = ± 1/32" .XX = ± .010 .XX = ± .002 DEG. = ± 1/2°		SCALE : None	RELEASE DATE :
DRAWN BY : S.V.		DATE : 2/11/99	
APPROVED BY :		DATE :	
NOTE :		DRAWING NUMBER	REV.NO.
		2005 - A	1.0