

NOTE: NBTLSST & NCTLSST EDUCATORS HAVE THE SAME OPERATING CHARACTERISTICS

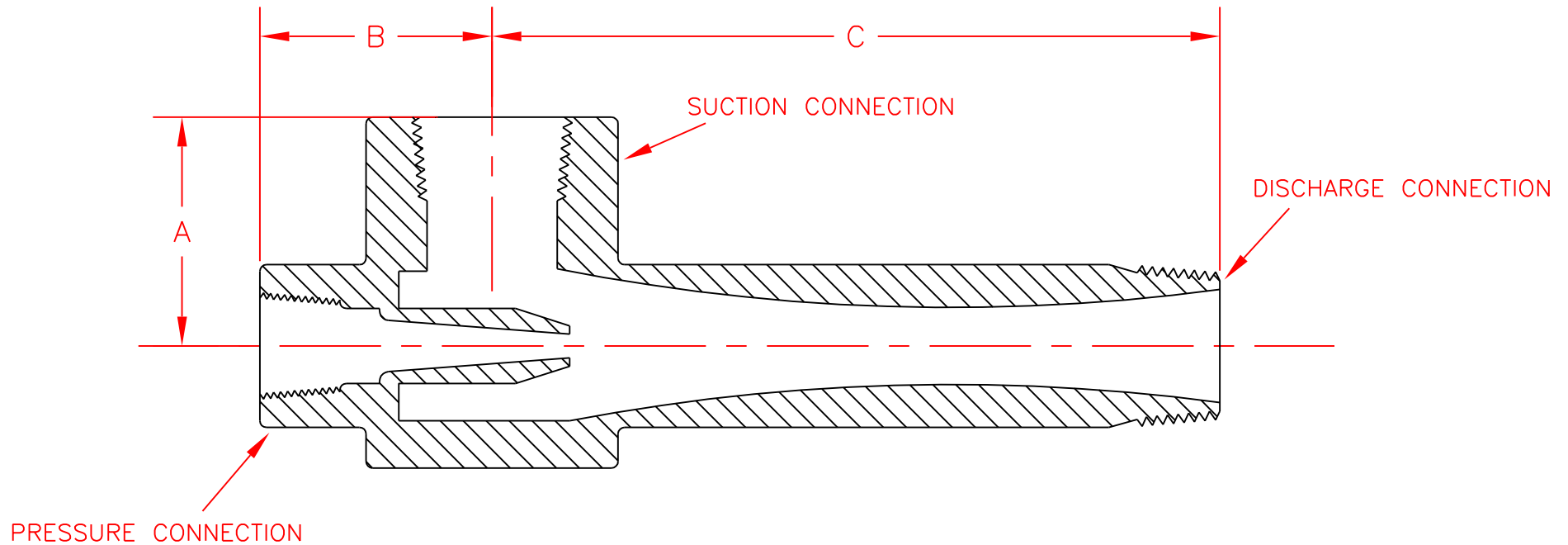

CAPACITY FACTOR	MODEL	DIM. A	DIM. B	DIM. C	PRESSURE CONNECTION	SUCTION & DISCHARGE CONNECTION
0.091	NBTLSST1	1-1/4"	1-1/2"	3"	3/8" NPT	1/2" NPT
0.165	NBTLSST2	1-3/8"	1-7/16"	3-7/16"	1/2" NPT	3/4" NPT
0.30	NBTLSST3	1-3/4"	1-7/8"	4-1/2"	3/4" NPT	1" NPT
0.55	NBTLSST4	2"	1-15/16"	6-1/4"	1" NPT	1-1/2" NPT
1.00	NBTLSST5	2"	2"	8"	1" NPT	1-1/2" NPT
1.80	NBTLSST6	3"	3-1/4"	10-7/8"	1-1/2" NPT	2" NPT
3.24	NBTLSST7	3-1/2"	4-3/4"	14-1/2"	2" NPT	2-1/2" NPT
4.30	NBTLSST8	4"	5"	16"	2" NPT	3" NPT
5.71	NBTLSST9	4"	5"	19-1/8"	2" NPT	3" NPT
7.57	NBTLSST10	5-1/4"	10-1/2"	22"	3" NPT	4" NPT
10.1	NBTLSST11	5-1/4"	10-1/2"	25-3/8"	3" NPT	4" NPT

PRELIMINARY

DO NOT SCALE

NO.	DATE	REVISION	BY
TORONTO, ONTARIO CANADA LIVONIA, MICHIGAN USA			
PROJECT : Liqui-Jet Solids Educators			
PART : NBTLSST Dimensions - Welded Style			
MATERIAL :			QTY.:
UNLESS OTHERWISE SPECIFIED, GENERAL TOLERANCES: X/X = ± 1/32" XX = ± .010 XXX = ± .002 DEG. = ± 1/2°		SCALE : None	RELEASE DATE :
		DRAWN BY : B.W.	DATE : 10/95
		APPROVED BY :	DATE :
NOTE :		DRAWING NUMBER	REV.NO.
		TLS-NBTLSST-6-D	2065 -A 1.0

DIMENSIONS AND SPECIFICATIONS ARE SUBJECT TO CHANGE WITHOUT NOTICE